

flexyPage Displays

LT-Line 15,6 (39,6 cm)

Model: 2019 12V + 24V

Mechanical Drawings



About flexyPage documentation

This document provides an overview of possibilities of what can be realised with the flexyPage system. It constitutes only a small part of the whole documentation and is undergoing continual improvement.



The documents, images, graphics and videos, as well as hard and software are protected by copyright. It is prohibited to copy or circulate this document without prior written consent. Translations do also require a written declaration of consent. The ELFIN GmbH is sole contact regarding copies, translations and similar concerns.

This documentation is continuously revised and updated with the greatest of care. Nevertheless, errors cannot be excluded. We are pleased to hear your comments, helpful references and suggestions about this documentation. Please contact our sales department or support for that.

The ELFIN GmbH will not accept any liability for errors or any potential damage and their consequences in conjunction with delivery or usage of this document.

Please carefully read the user manuals, product data sheets, safety instructions and mounting instructions before using!



The actual user manual as well as other documents and application cases can be found at the product website:

Introduction to the flexyPage system
Quick starting guide
Video tutorials
flexyPage user manual
Widget descriptions
Product data sheets
Frequently asked questions
Sales contact
Support contact
Manufacture homepage

flexypage.de/en/documentation
flexypage.de/en/documentation
flexypage.de/en/tags/video-tutorials
flexypage.de/en/documentation
flexypage.de/en/doc/widget-descriptions
flexypage.de/en/documentation
flexypage.de/en/faq
flexypage.de/en/sales
flexypage.de/en/support
elfin.de

Dimensions flexyPage display

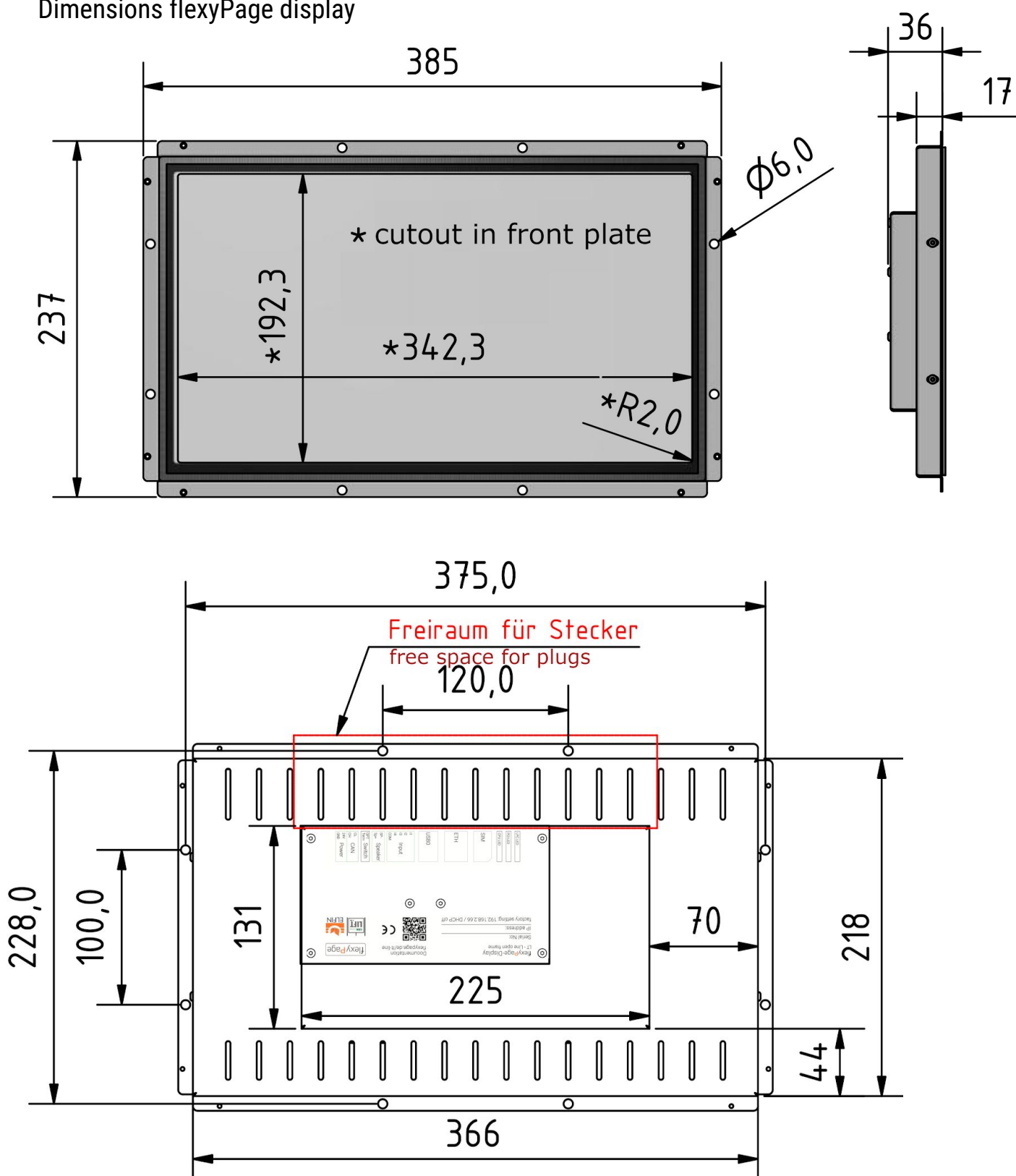

Order No.: fel4x-02A-156A subject to modifications	Title Mechanical drawing LT-Line 15,6 2019 open frame		
	Drawing No.: fel4x-02A-156A_MD_V1.0		
Tolerances +/- 0,5 mm	Scale:	Date: 2019-12-03	Drawn by: VSc

Accessory parts - dimensions stainless steel frame for flexyPage display

stainless steel frame with welding studs M3 x 20 mm

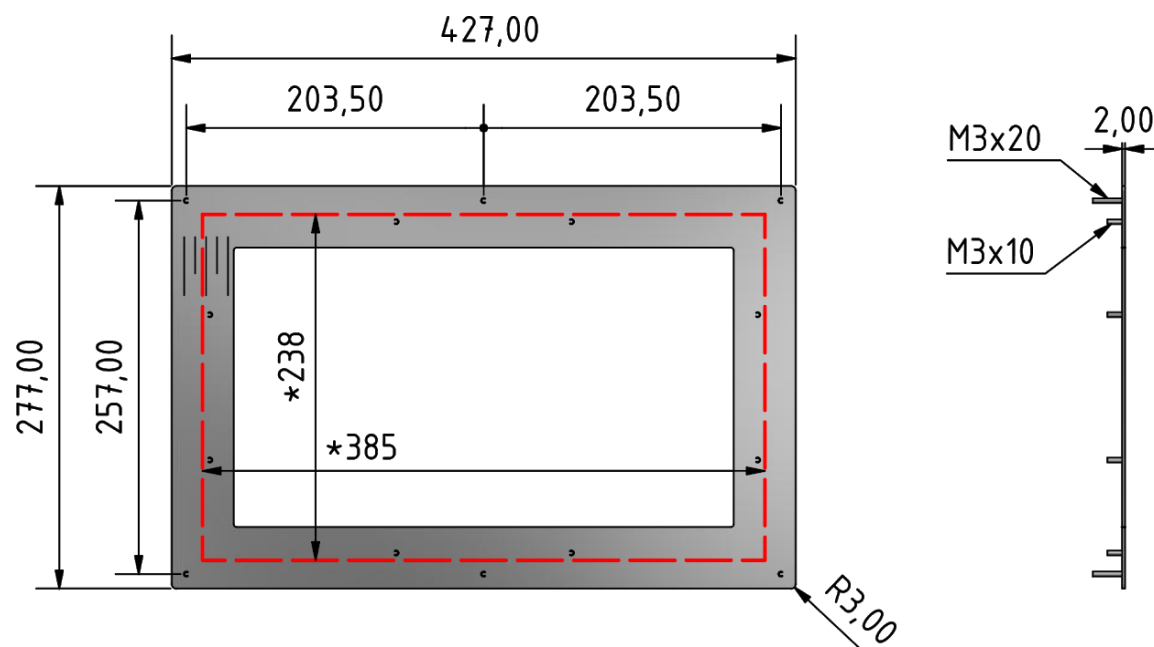

*external dimensions display / monitor

stainless steel frame with countersunk holes M4

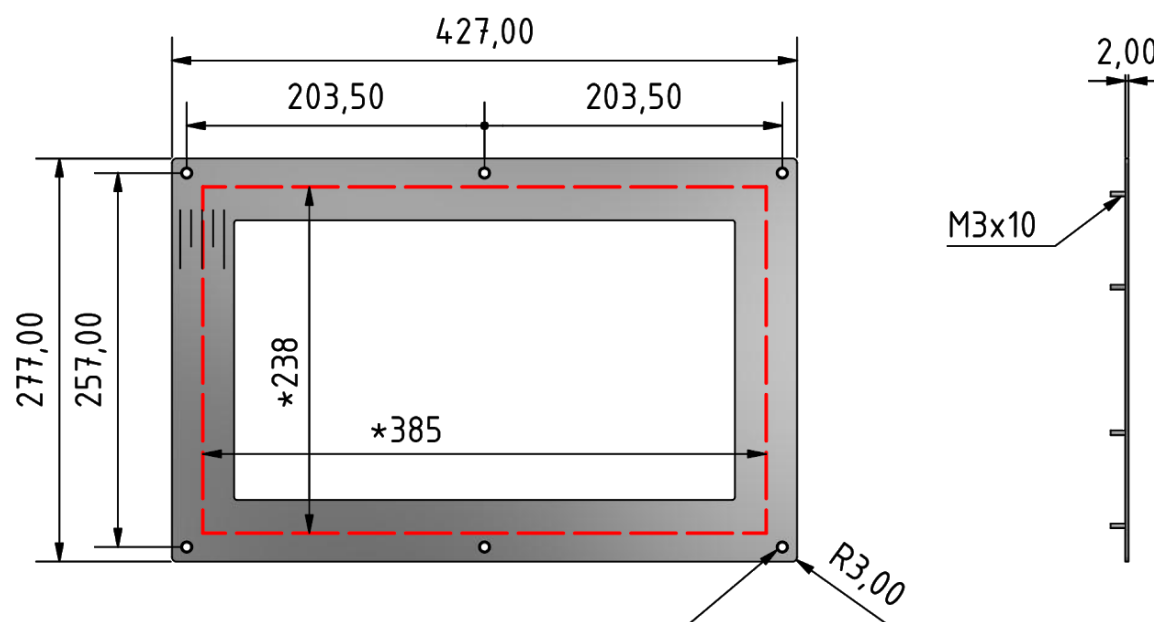

*external dimensions display / monitor

countersunk holes M4

Order No.: welding studs: zbs1A-02A-156A-FEB countersunk holes: zbs1A-02A-156A-FES subject to modifications	Title stainless steel frame for LT-Line 15,6 open frame		
	Drawing No.: fel4x-02A-156A_stainless_steel_frames_V1.0		
Tolerances +/- 0,1 mm	Scale:	Date: 2019-12-03	Drawn by: VSch

Cutout

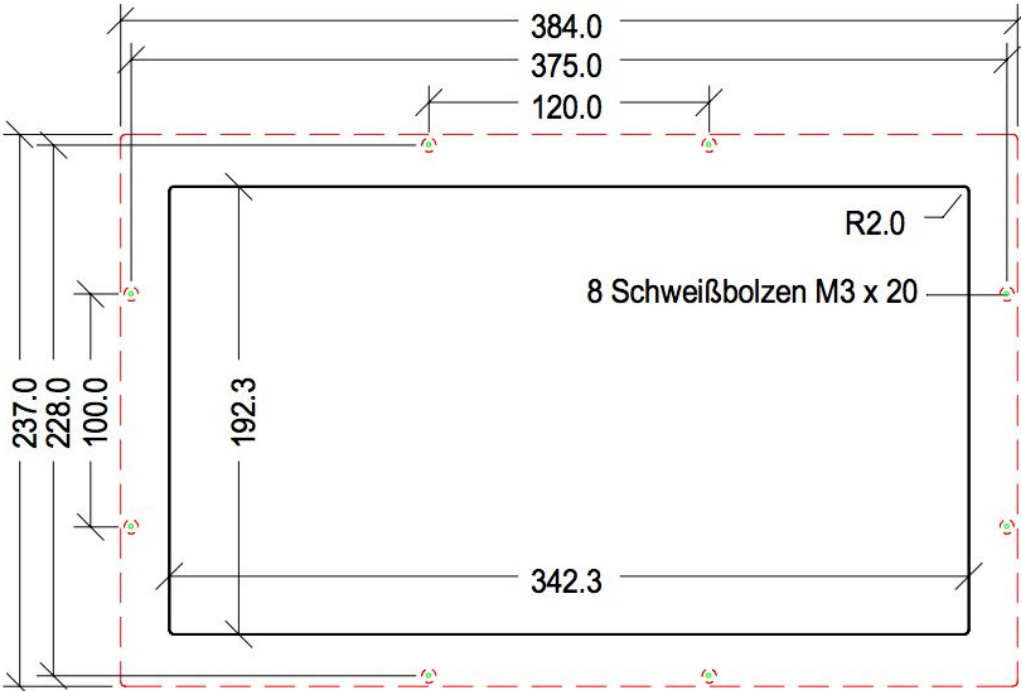
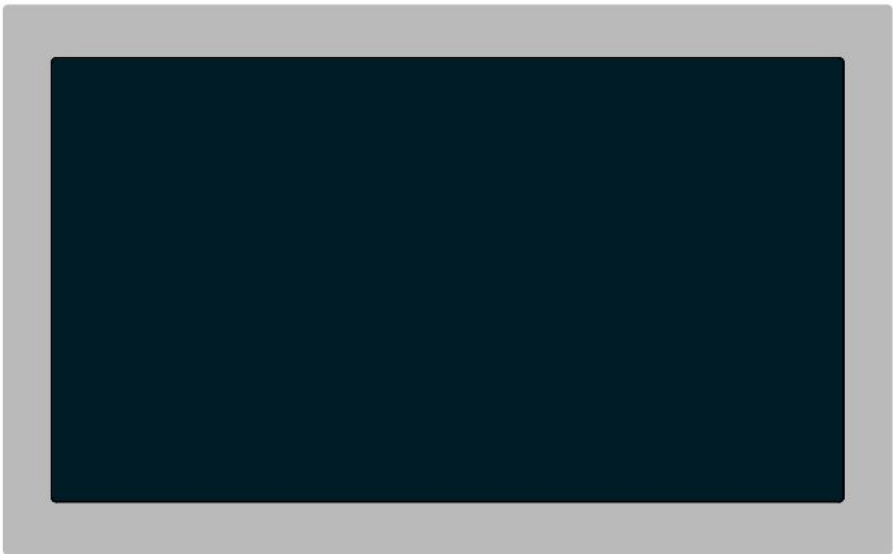

Order No.: subject to modifications	Title Cutout LT-Line 15,6 open frame		
	Drawing No.: fel4x-02A-156A_cutout_V1.0		
Tolerances +/- 0,1 mm	Scale:	Date: 2015-06-28	Drawn by: JHell

Accessory parts - VSG safety glass panel + acrylic glass panel for 2 mm front panel

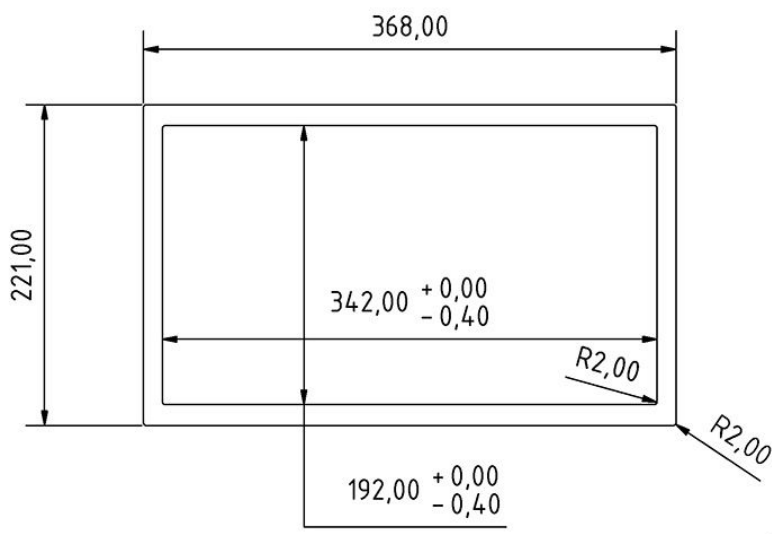

VSG safety glass
6 mm for 2 mm front panel

Acrylic glass
4 mm for 2 mm front panel

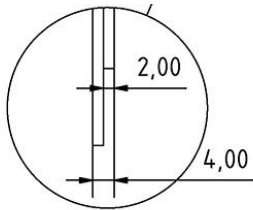
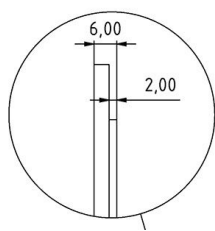

Order No.	Description
zbs1A-02A-156A-SPE	acrylic glass LT-Line 15,6 (39,6 cm) anti-glare
zbs1A-02A-156A-SGE	VSG safety glass LT-Line 15,6 (39,6 cm) anti-glare

Order No.: zbs1A-02A-156A-... subject to modifications	Title cover glass LT-Line 15,6 open frame		
	Drawing No.: fel4x-02A-156A_cover_glass_V1.0		
Tolerances +/- 0,1 mm	Scale:	Date: 2016-10-09	Drawn by: JHell

Document history

Version	Release Date	Changes
1.0	2015-01-20	final version
1.1	2016-10-12	new label on product, new document structure
1.2	2018-06-18	typo
1.3	2019-02-26	new mechanical drawings
1.4	2019-12-03	typo
1.5	2021-02-18	New glass drawings

Your contact at ELFIN

Even an extensive documentation cannot answer every question. Do you still have questions or suggestions concerning our flexyPage system? We look forward to your requests! Please don't hesitate to contact us at:

ELFIN Technology GmbH

Siegburger Straße 215

50679 Cologne

Germany

Phone: +49 (221) 6778932-0

FAX: +49 (221) 6778932-2

service@elfin.de

www.elfin.de



Sales flexyPage

flexypage.de/en/sales

Phone: +49 (221) 6430816-2

FAX: +49 (221) 6778932-2

sales@flexyPage.de



innovative display solutions

Support flexyPage

flexypage.de/en/support

Phone: +49 (221) 6430816-3

support@flexyPage.de