

Fire protection industrial monitor

FL-Line 24 (61 cm)

Model: 2019 230V

Mechanical Drawings

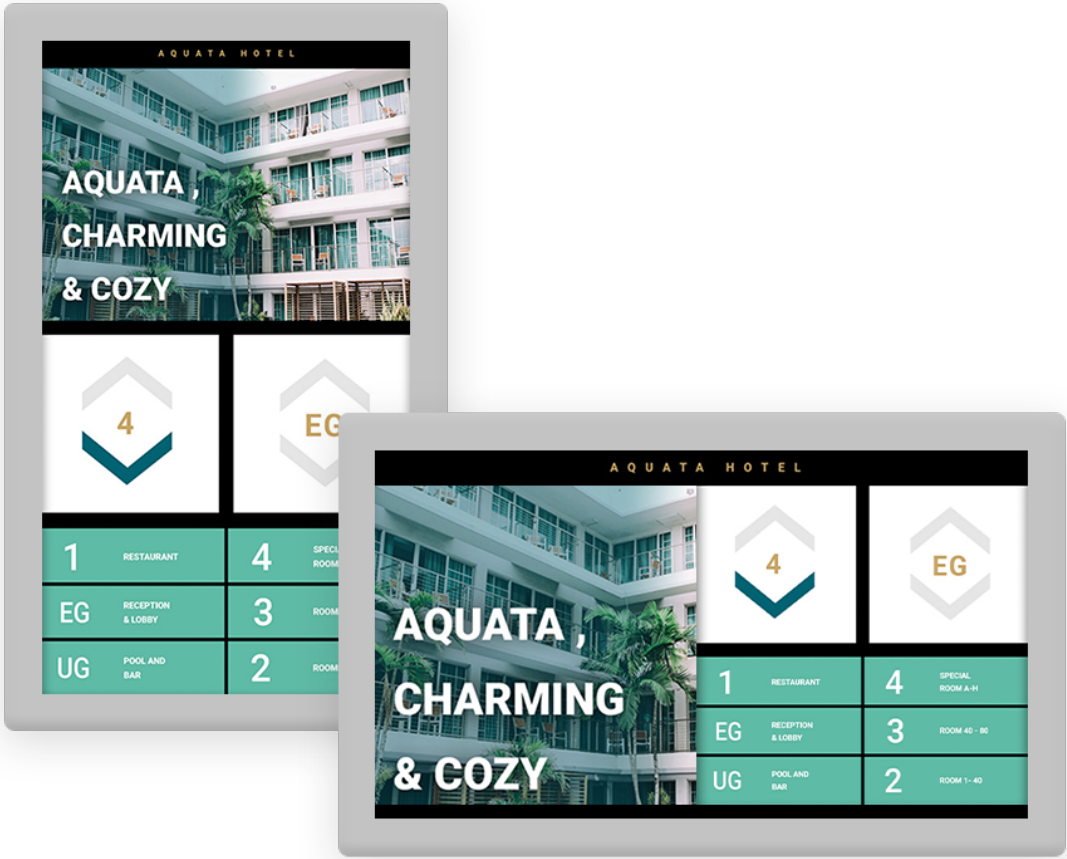

About flexyPage documentation



This document provides an overview of possibilities of what can be realised with the flexyPage system. It constitutes only a small part of the whole documentation and is undergoing continual improvement.

The documents, images, graphics and videos, as well as hard and software are protected by copyright. It is prohibited to copy or circulate this document without prior written consent. Translations do also require a written declaration of consent. The ELFIN GmbH Technology is sole contact regarding copies, translations and similar concerns.

This documentation is continuously revised and updated with the greatest of care. Nevertheless, errors cannot be excluded. We are pleased to hear your comments, helpful references and suggestions about this documentation. Please contact our sales department or support for that.

The ELFIN GmbH Technology will not accept any liability for errors or any potential damage and their consequences in conjunction with delivery or usage of this document.

Please carefully read the user manuals, product data sheets, safety instructions and mounting instructions before using!



The actual user manual as well as other documents and application cases can be found at the product website:

Introduction to the flexyPage system
Quick starting guide
Video tutorials
flexyPage user manual
Widget descriptions
Product data sheets
Frequently asked questions
Sales contact
Support contact
Manufacture homepage

flexypage.de/en/documentation
flexypage.de/en/documentation
flexypage.de/en/tags/video-tutorials
flexypage.de/en/documentation
flexypage.de/en/doc/widget-descriptions
flexypage.de/en/documentation
flexypage.de/en/faq
flexypage.de/en/sales
flexypage.de/en/support
elfin.de

Dimensions monitor landscape

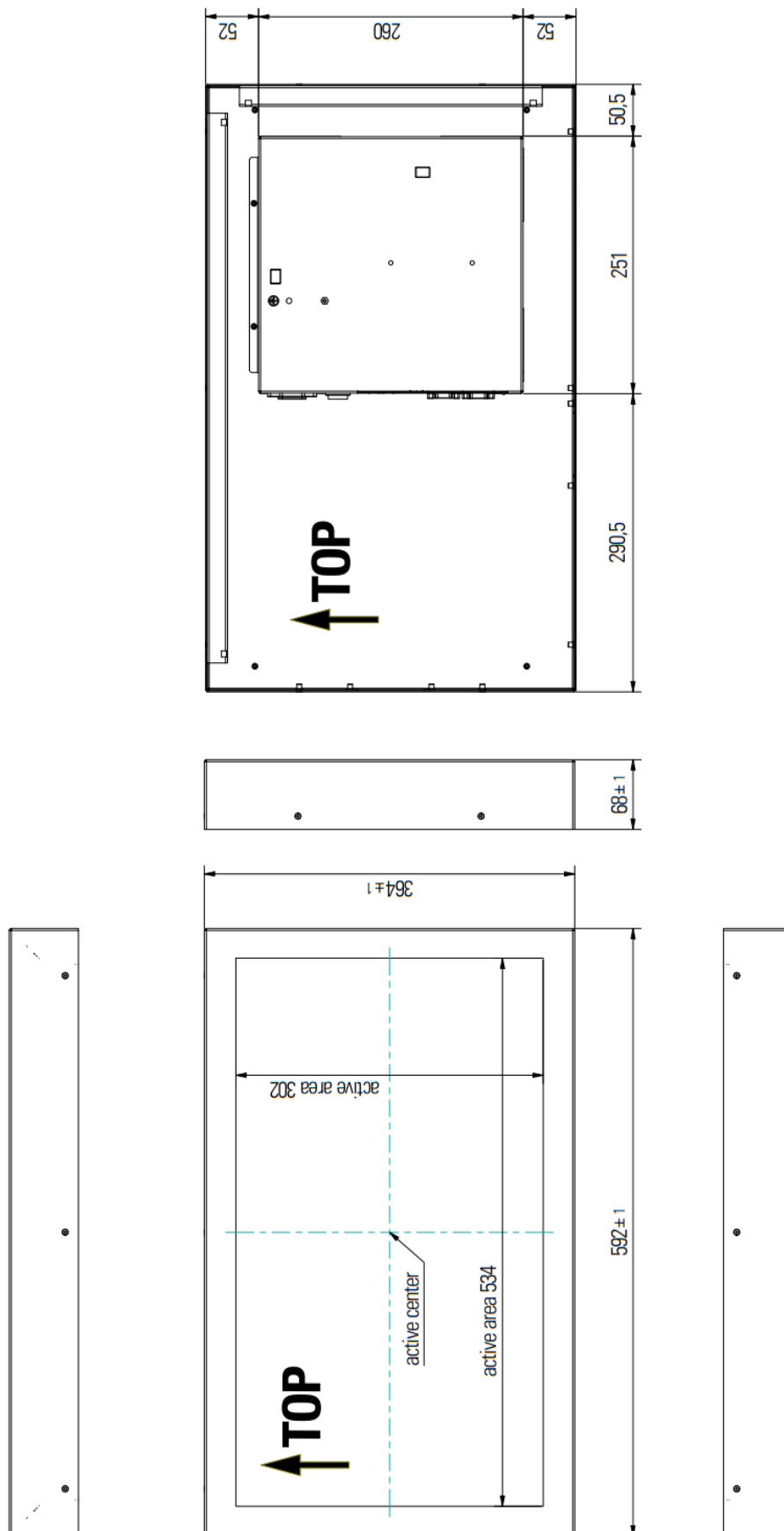

| | | | |
|--|---|------------------|-----------|
| Order No.: ddg-fl-24-V2L subject to modifications | Title Mechanical drawing FL-Line 24 V2 Landscape monitor | | |
| | Drawing No.: FL-24A_V2_Landscape_MD_V1.0 | | |
| Tolerances +/- 0,1 mm | Scale: | Date: 2023-04-28 | Drawn by: |

Wallmount dimensions monitor landscape

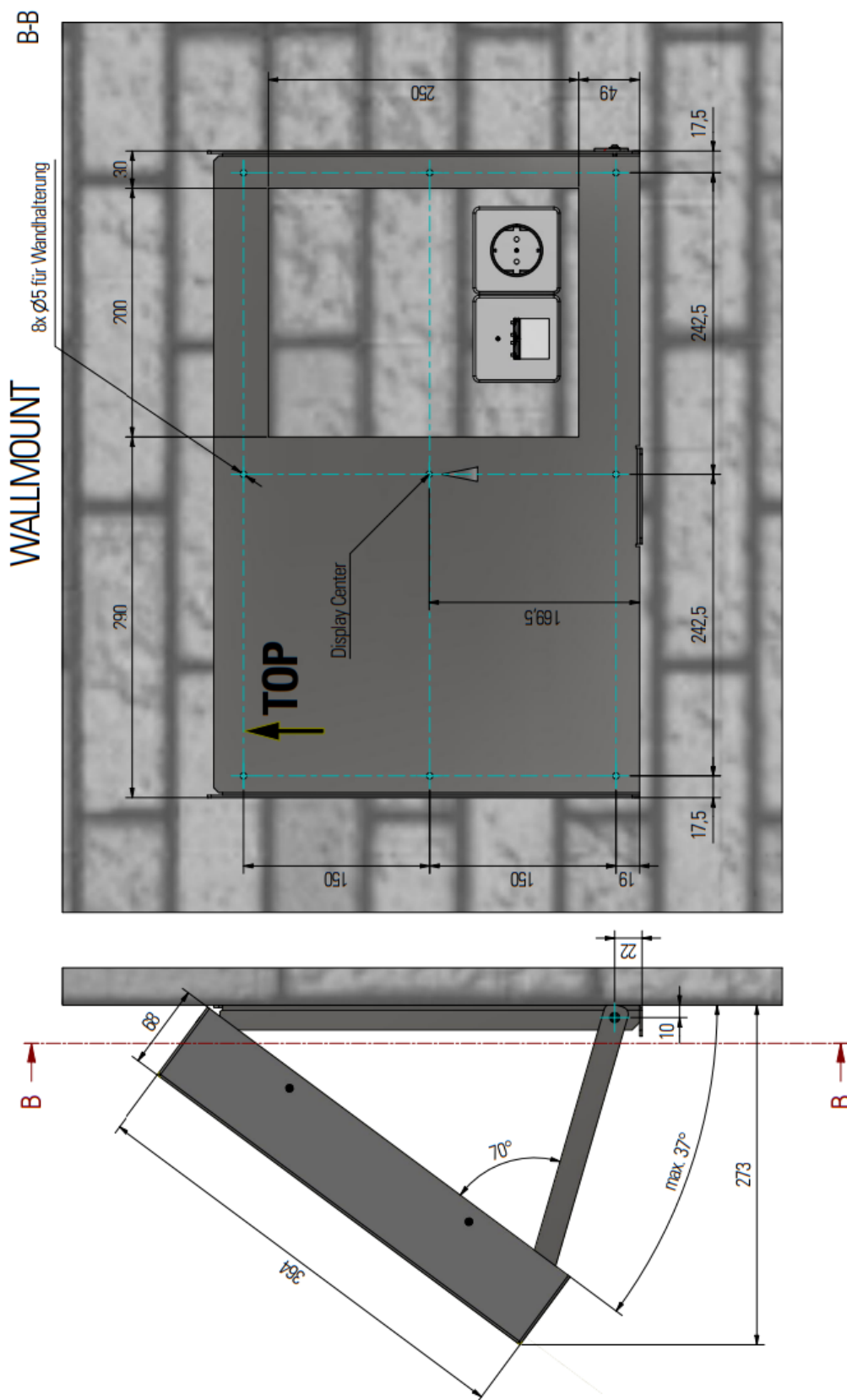

| | | | |
|--|---|------------------|-----------------|
| Order No.: ddg-fl-24-V2L subject to modifications | Title Mechanical drawing FL-Line 24 V2 Landscape monitor wallmount | | |
| | Drawing No.: FL-24A_V2_wallmount_MD_V1.0 | | |
| Tolerances +/- 0,1 mm | Scale: | Date: 2023-04-28 | Drawn by: JHell |

Dimensions monitor portrait

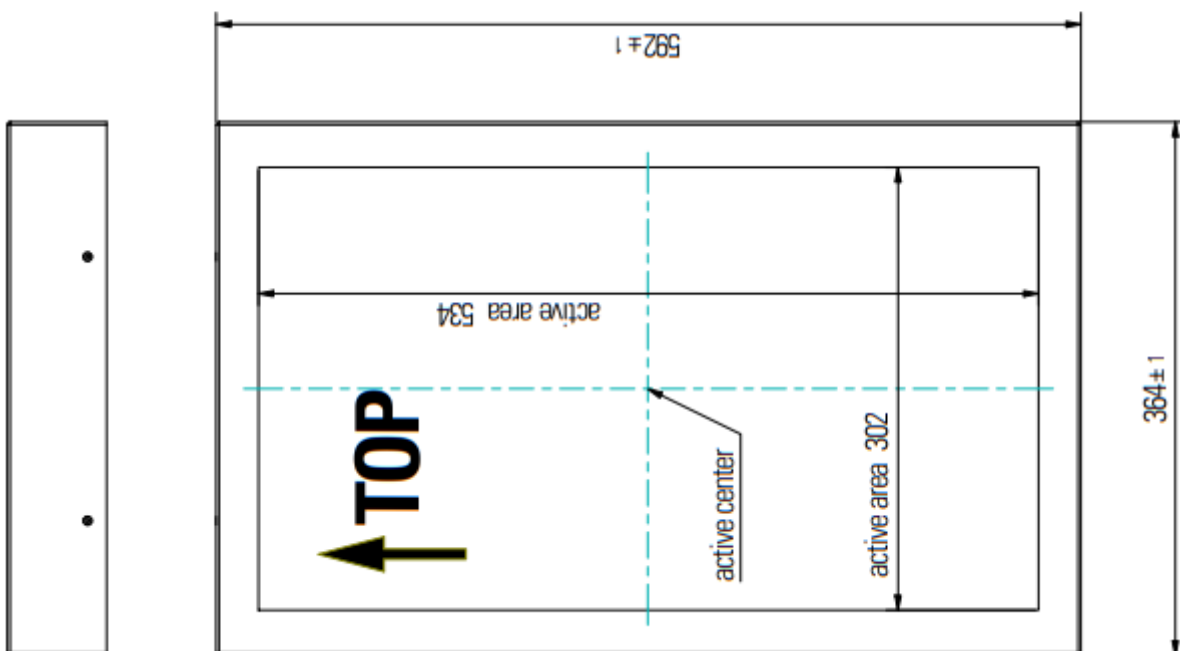
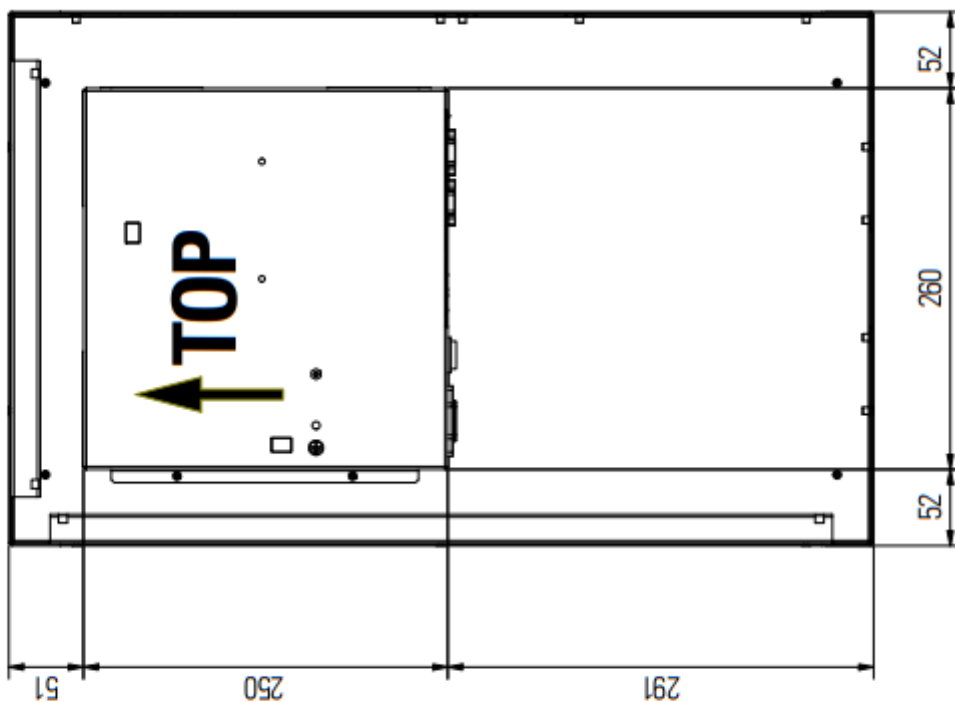

| | | | |
|--|--|------------------------|-----------|
| Order No.: ddg-fl-24-V2P subject to modifications | Title Mechanical drawing FL-Line 24 V2 Portrait monitor | | |
| | Drawing No.: FL-24A_V2_Portrait_MD_V1.0 | | |
| Tolerances +/- 0,1 mm | Scale: | Date: Date: 2023-04-28 | Drawn by: |

Wallmount dimensions monitor portrait

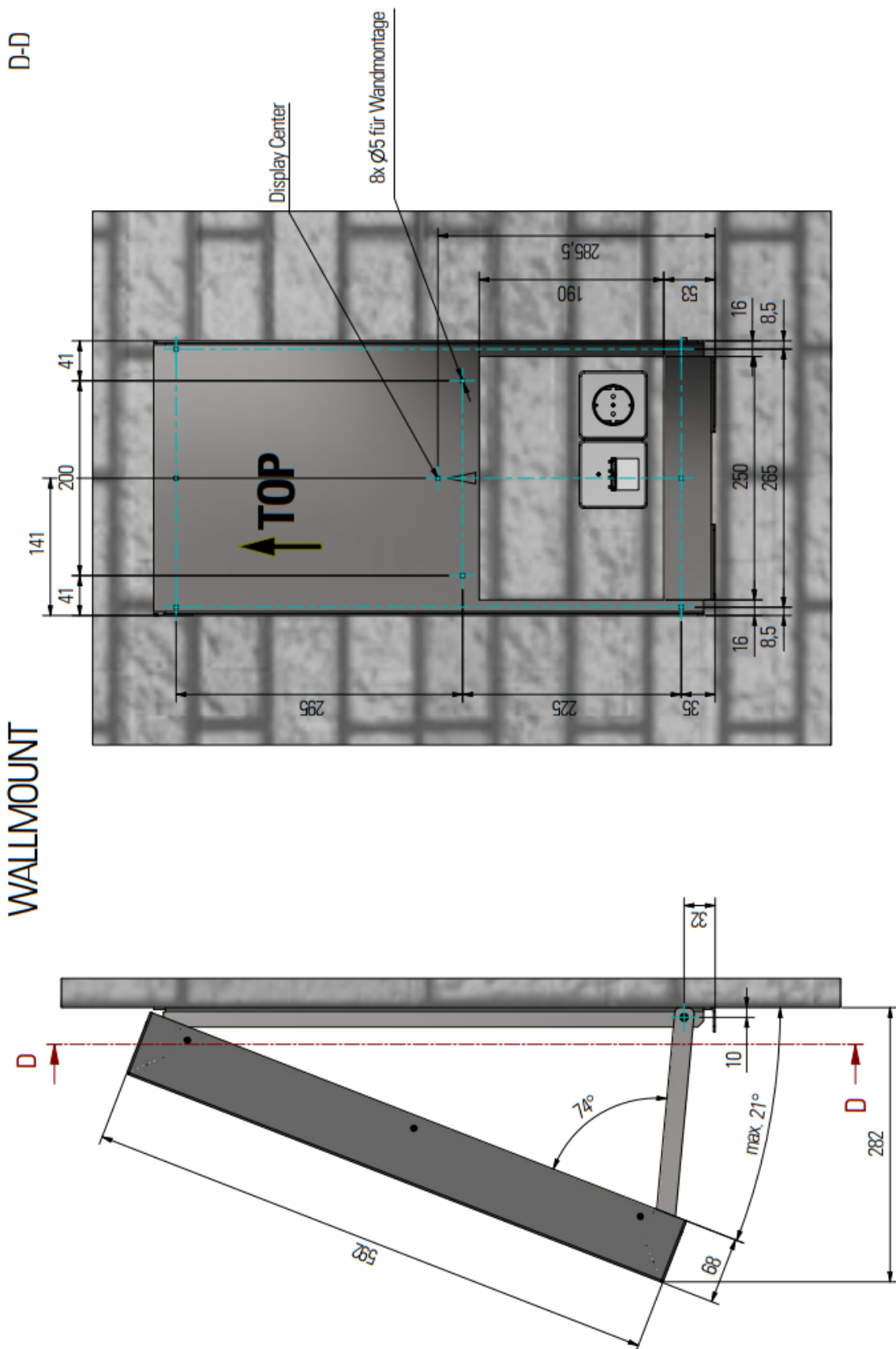

| | | | |
|--|--|------------------|-----------|
| Order No.: ddg-fl-24-V2P subject to modifications | Title Mechanical drawing FL-Line 24 V2 Portrait monitor wallmount | | |
| | Drawing No.: FL-24A_V2_wallmount_MD_V1.0 | | |
| Tolerances +/- 0,1 mm | Scale: | Date: 2023-04-28 | Drawn by: |

Document history

| Version | Release Date | Changes |
|---------|--------------|---------------|
| 0.1 | 2023-04-28 | Pre version |
| 1.0 | 2023-05-03 | Final version |

Your contact persons

Even an extensive documentation cannot answer all questions. Do you have questions or suggestions concerning our flexyPage system? We look forward to your requests. You can contact us at:



ELFIN Technology GmbH

Im Zollhafen 22
50678 Cologne
Germany
Phone: +49 (221) 6778932-0
FAX: +49 (221) 6778932-2
service@elfin.de
www.elfin.de



innovative display solutions

flexyPage Sales

flexypage.de/en/sales
Phone: +49 (221) 6430816-2
FAX: +49 (221) 6778932-2
sales@flexyPage.de

flexyPage Support

flexypage.de/en/support
Phone: +49 (221) 6430816-3
support@flexyPage.de

www.flexyPage.de